

TANNER STREET

GROUND FLOOR – HUB

This ground floor space would possibly form the entrance, registration, box office and foyer space.

The access from the street is through the double doors in the left of the top picture.



TANNER STREET

GARAGE & YARD SPACE

This space leads off from the Hub Space and could form two or three performance spaces.

The double green doors in the left of the top picture lead to the yard.

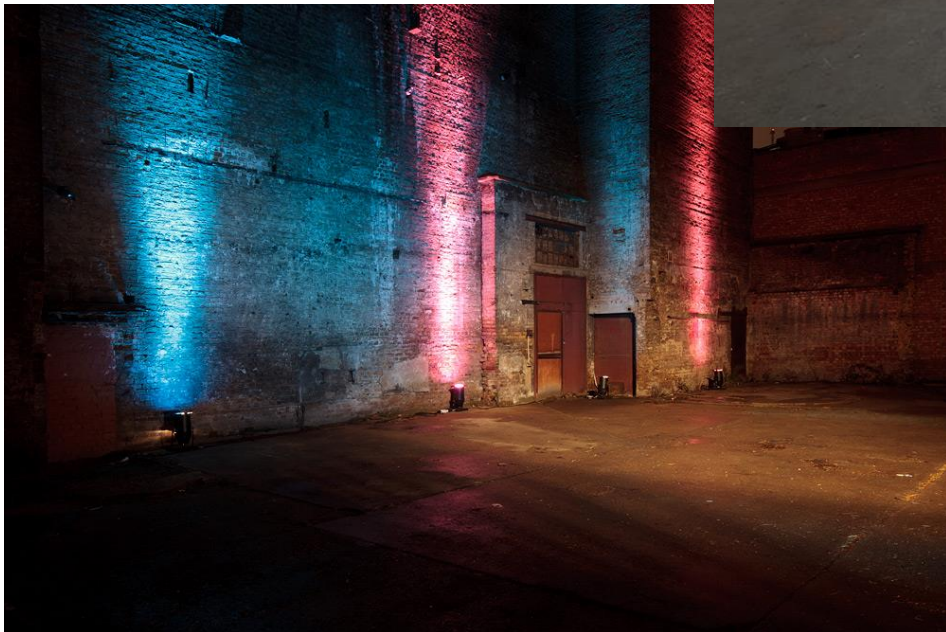

**TANNER STREET
PLANS**

HUB – access to Garage through
Doors top right and bottom left

Access to other floors and toilets
on the left

GARAGE – has various features, disused lift,
doors with smaller rooms off, double
doors to the Yard

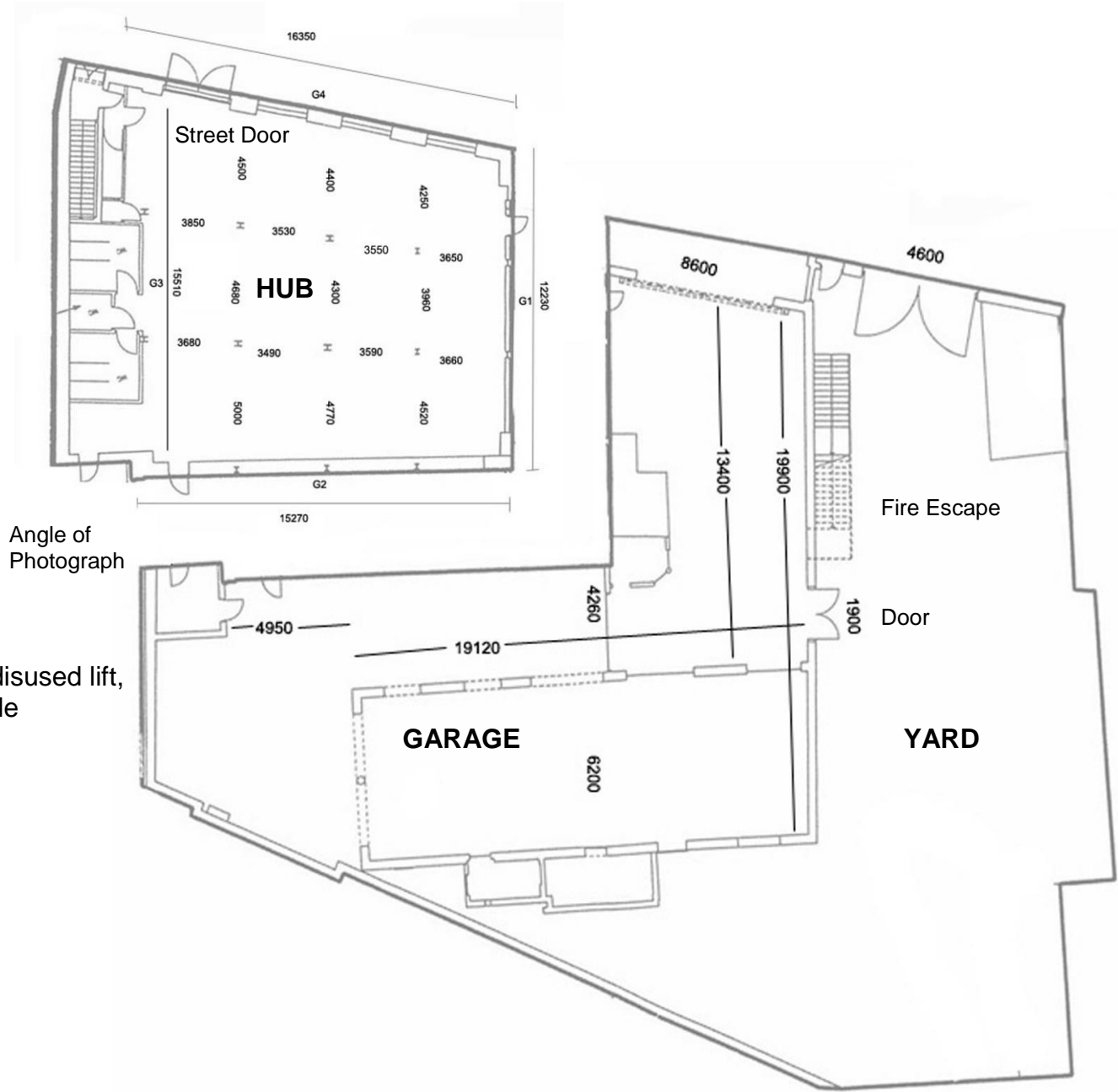

Angle of
Photograph